

Rod mounts with tabs

 Preferred type, readily available (codes marked in red)



Stainless steel



Polyamide

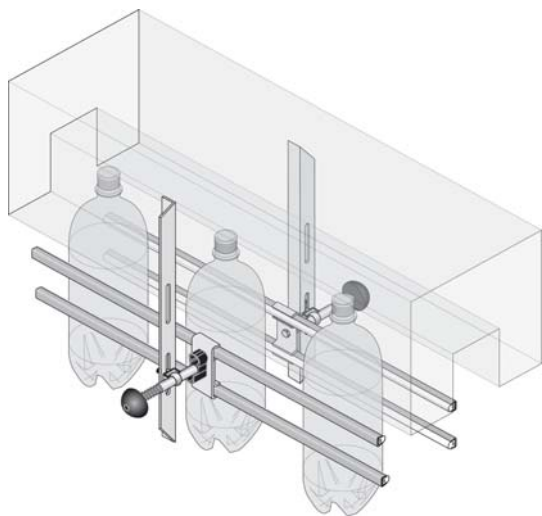

VALU GUIDE ROD MOUNTS

New Valu Guide Rod Mounts, used for holding and positioning adjusting rods. These strong, yet economical mounts are available in a selection of rod diameter sizes, fixed or rotating configurations, and various tightening methods.

Positioning tabs lock the rod to brackets slots at 90°.

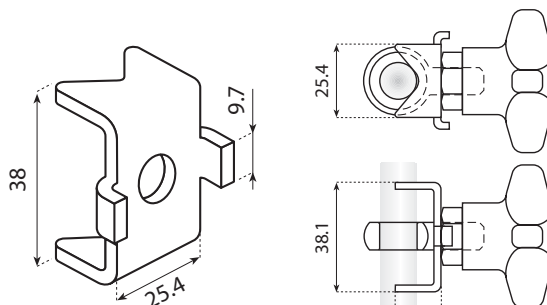

16mm (12-13mm rod)
17.5mm (14mm rod)
19mm (16mm rod)
22mm (20mm rod)

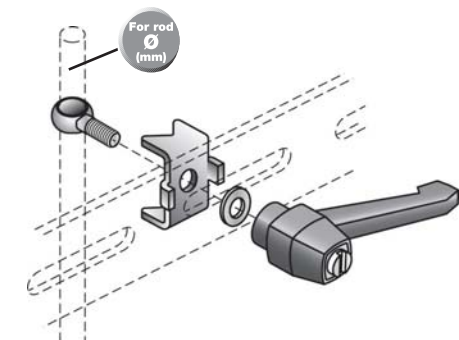
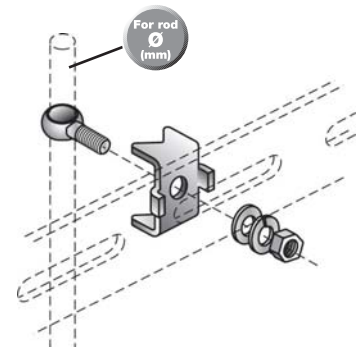
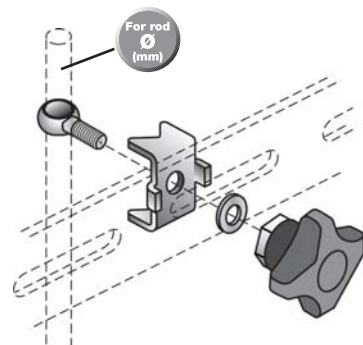
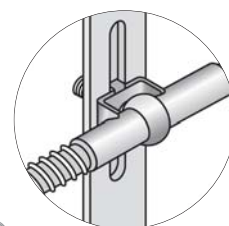

ROD MOUNTS WITH TABS

Material: rod mounts in stainless steel, eyebolt and washer in stainless steel, knob in polyamide with nickel plated brass insert.

Code	Ref.	For rod Ø (mm)	
13S00162	VG-641T-K-12	12-13	
13S00163	VG-641T-K-14	14	
13S00165	VG-641T-K-58	16	n°8
13S00164	VG-641T-K-20	20	

ROD MOUNTS WITH TABS

Material: all components are in stainless steel.

Code	Ref.	For rod Ø (mm)	
13S00166	VG-641T-N-12	12-13	
13S00167	VG-641T-N-14	14	
13S00169	VG-641T-N-58	16	n°8
13S00168	VG-641T-N-20	20*	

* Ø20 version can be converted to SpeedSet brackets.

ROD MOUNTS WITH TABS

Material: rod mounts, eyebolt and washer in stainless steel knob in polyamide with nickel plated brass insert.

Code	Ref.	For rod Ø (mm)	
13S00170	VG-641T-R-12	12-13	
13S00171	VG-641T-R-14	14	
13S00173	VG-641T-R-58	16	n°8
13S00172	VG-641T-R-20	20	

Rod mounts without tabs

Preferred type, readily available (codes marked in red)



Stainless steel



Polyamide

VALU GUIDE ROD MOUNTS

New Valu Guide Rod Mounts, used for holding and positioning adjusting rods. These strong, yet economical mounts are available in a selection of rod diameter sizes, fixed or rotating configurations, and various tightening methods.

Rod can be rotated to any angle desired.

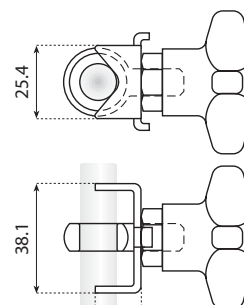
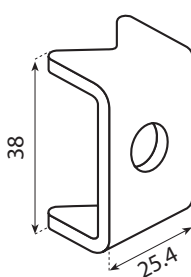
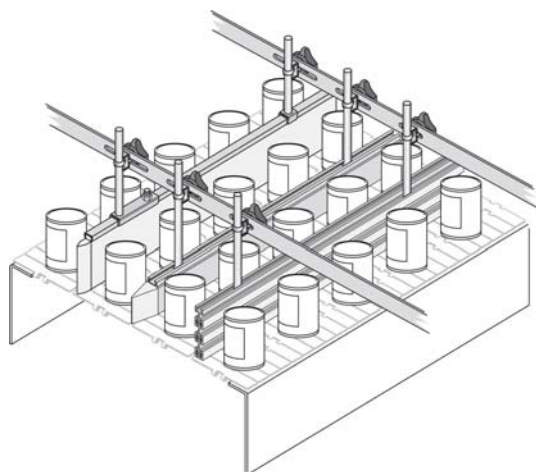

16mm (12-13mm rod)
17.5mm (14mm rod)
19mm (16mm rod)
22mm (20mm rod)

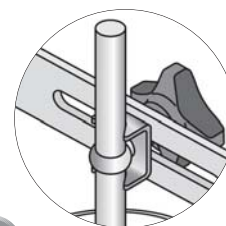

ROD MOUNTS WITH TABS

Material: rod mounts eyebolt and washer are in stainless steel, knob in polyamide with nickel plated brass insert.

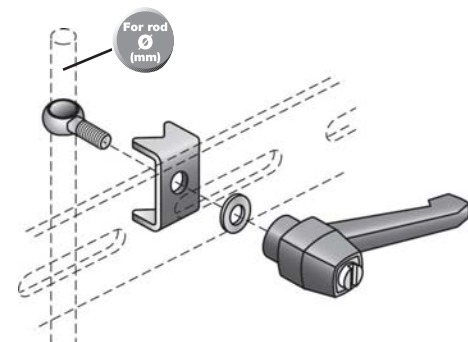
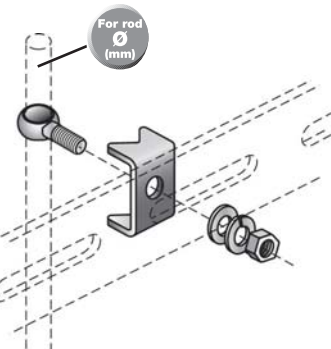
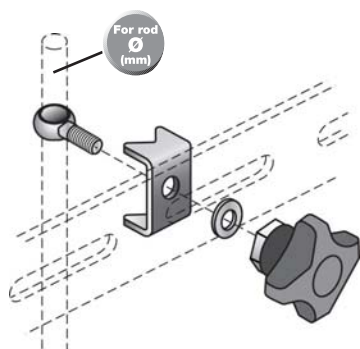

Code	Ref.	For rod Ø (mm)	
13S00150	VG-641-K-12	12-13	n°8
13S00151	VG-641-K-14	14	
13S00153	VG-641-K-58	16	
13S00152	VG-641-K-20	20	

ROD MOUNTS WITH TABS

Material: all components are in stainless steel.

Code	Ref.	For rod Ø (mm)	
13S00154	VG-641-N-12	12-13	n°8
13S00155	VG-641-N-14	14	
13S00157	VG-641-N-58	16	
13S00156	VG-641-N-20	20*	

* Ø20 version can be converted to SpeedSet brackets.

ROD MOUNTS WITH TABS

Material: rod mounts, eyebolt and washer in stainless steel, knob in polyamide with nickel plated brass insert.

Code	Ref.	For rod Ø (mm)	
13S00158	VG-641-R-12	12-13	n°8
13S00159	VG-641-R-14	14	
13S00161	VG-641-R-58	16	
13S00160	VG-641-R-20	20	