

Quick release adjustable heads

 Preferred type, readily available (codes marked in red)

QUICK RELEASE ADJUSTABLE HEADS

For fast line changes the new head from System Plast provides simplicity and easy in achieving the accuracy needed in adjusting multiple stations simultaneously.

- This new patented part is perfect for applications where accurate and / or frequent adjustments are required.
- Fits 12-14 mm diameter adjusting rods.
- Corrosion resistance composite components.
- Ergonomic spring loaded design.

Components:

- External Housing (polyamide)
- Internal Housing (see the table)
- Closing Cap (polyamide)
- Spring (steel)
- Screw and washer (stainless steel AISI 304)
- Nut (nickel plated brass)

Advantages:

- Rapid adjustment of guides to accommodate the choice of bottle format.
- Quick and easy maintenance.

Supply: assembled.

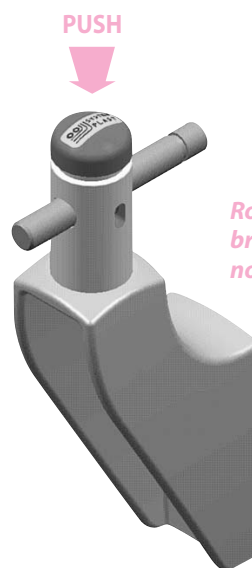

AISI 304
Stainless steel



Nickel plated brass



Polyamide



Accessories

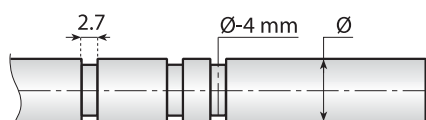

Rod dimensions

Code	Internal block	For rod Ø (mm)	
13300	Reinforced polyamide	12	n°50
13301		14	
13302	Nickel plated brass	12	n°50
13303		14	

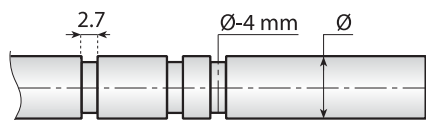
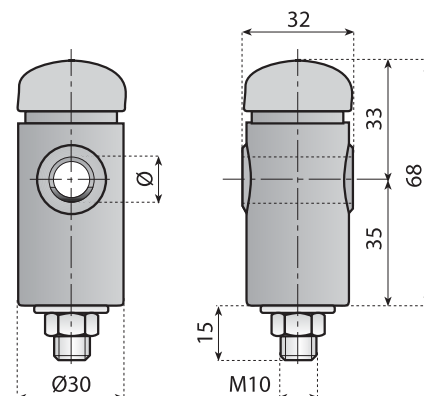

Rod dimensions

Code	Internal block	For rod Ø (mm)	
13302FP	Nickel plated brass	12	n°50
13303FP		14	

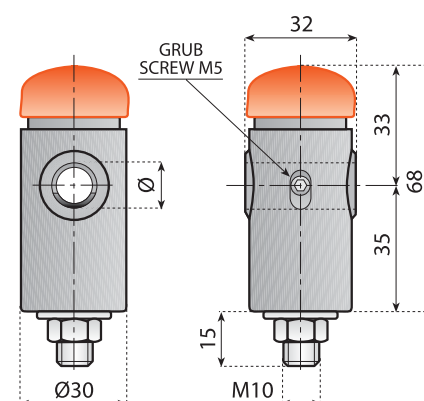

For a correct use of these products and to get the best performance, please call our engineering experts.