

Adjustable brackets

 Preferred type, readily available (codes marked in red)



AISI 304
Stainless steel



Nickel plated brass



Reinforced
polyamide



Accessories



BRACKET

Code

13040



n°50



Material

PA-FG

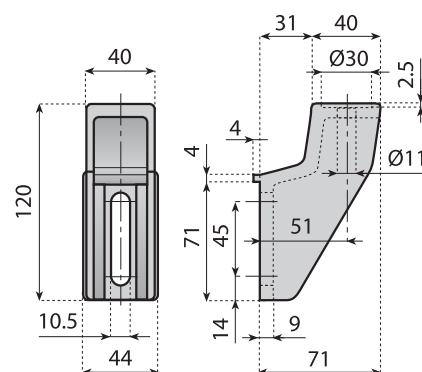

ADJUSTABLE BRACKET

Material: bracket and adjustable head in reinforced polyamide; eyebolt, nut and washer in stainless steel AISI 304.

Note: nut regulates rod position and head adjustability. Max recommended tightening torque 4 Kgm.

Code

13041

13042

13043



12

14

16



n°50

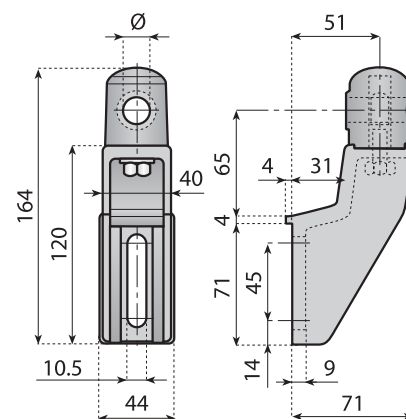

ADJUSTABLE BRACKET

Material: bracket and adjustable head in reinforced polyamide; threaded insert in nickel plated brass, screw and washer in stainless steel AISI 304.

Note: screw regulates rod position and head adjustability. Max recommended tightening torque 4 Kgm.

Code

13889

13890

13891



12

14

16



n°50

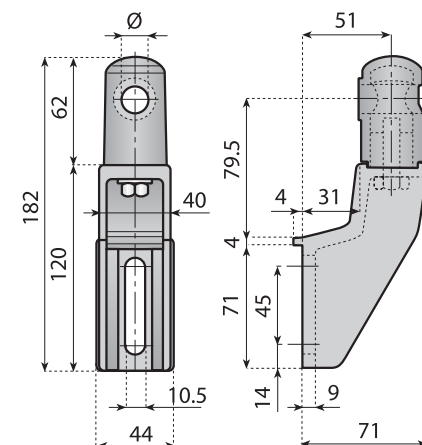

Adjustable brackets

Preferred type, readily available (codes marked in red)



AISI 304
Stainless steel



Nickel plated brass



Reinforced polyamide



Accessories



ADJUSTABLE BRACKET

Material: bracket and adjustable head in reinforced polyamide; eyebolt, nut, screws and washer in stainless steel AISI 304; knob in polyamide with nickel plated brass insert.

Note: screw regulates rod position and head adjustability.
Max recommended tightening torque 4 Kgm.

Code	For rod Ø (mm)	
13044	12	
13045	14	n°50
13046	16	

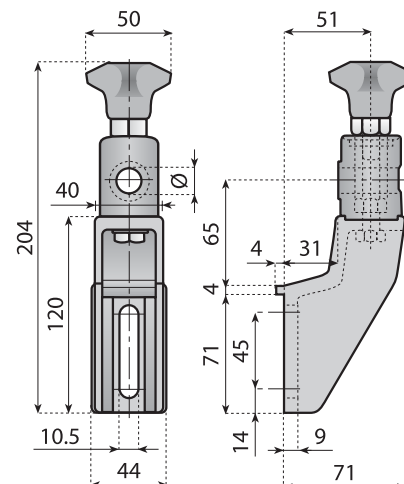

ADJUSTABLE BRACKET

Material: bracket and adjustable head in reinforced polyamide; eyebolt, nut, screws and washer in stainless steel AISI 304; knob in polyamide with nickel plated brass insert.

Note: screw regulates rod position and head adjustability.
Max recommended tightening torque 4 Kgm.

Code	For rod Ø (mm)	
13892	12	
13893	14	n°50
13894	16	

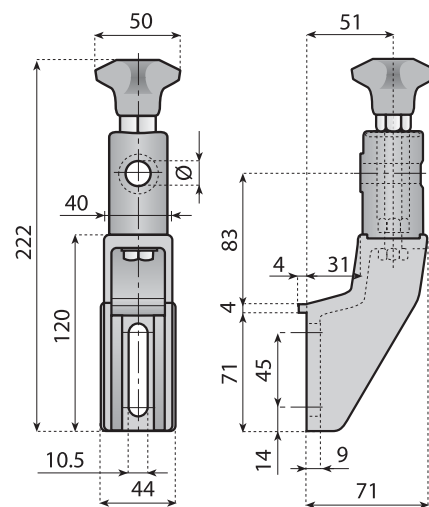

ADJUSTABLE BRACKET

Material: bracket in reinforced polyamide; screw and washer in stainless steel AISI 304; knob in polyamide with nickel plated brass insert.

Note: screw regulates rod position and head adjustability.
Max recommended tightening torque 4 Kgm.

Code	Head material	For rod Ø (mm)	
13100	Nickel	12	
13101	plated brass	14	n°50
13102		16	
13047	Stainless steel	12	
13048	AISI 304	14	n°50
13049		16	

