

Adjustable brackets

 Preferred type, readily available (codes marked in red)



AISI 304
Stainless steel



Nickel plated brass



Reinforced
polyamide



Accessories



BRACKET

Code

13185



n°50



PA-FG

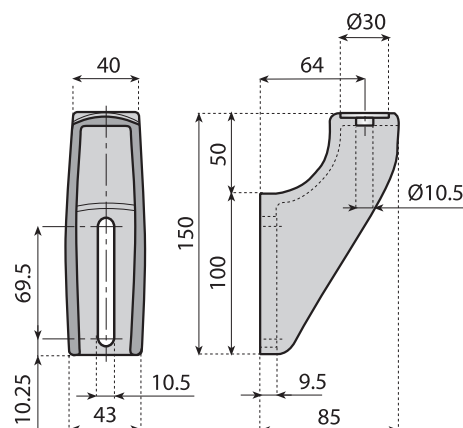

ADJUSTABLE BRACKET

Material: bracket and adjustable head in reinforced polyamide; eyebolt, nut and washer in stainless steel AISI 304.

Note: nut regulates rod position and head adjustability. Max recommended tightening torque 4 Kgm.

Code

13530

13531

13532



12

14

16



n°50

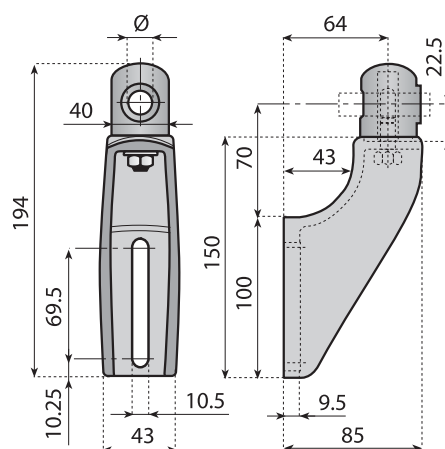

ADJUSTABLE BRACKET

Material: bracket and adjustable head in reinforced polyamide; bolt in nickel plated brass, screw and washer in stainless steel AISI 304.

Note: screw regulates rod position and head adjustability. Max recommended tightening torque 4 Kgm.

Code

13533

13534

13535



12

14

16



n°50

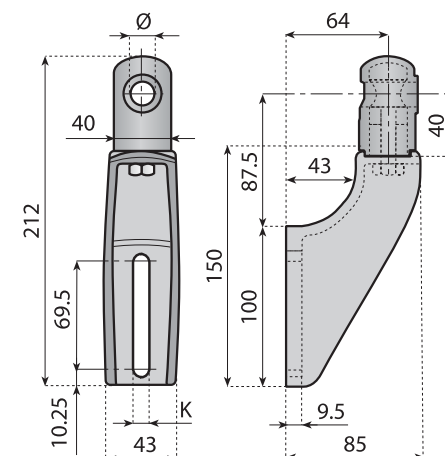

Adjustable brackets

Preferred type, readily available (codes marked in red)



AISI 304
Stainless steel



Nickel plated brass



Reinforced
polyamide



Accessories

ADJUSTABLE BRACKET

Material: bracket and adjustable head in reinforced polyamide; eyebolt, nut, screws and washer in stainless steel AISI 304; knob in polyamide with nickel plated brass insert.

Note: screw regulates rod position and head adjustability. Max recommended tightening torque 4 Kgm.

Code	For rod Ø (mm)	
13536	12	
13537	14	n°50
13538	16	

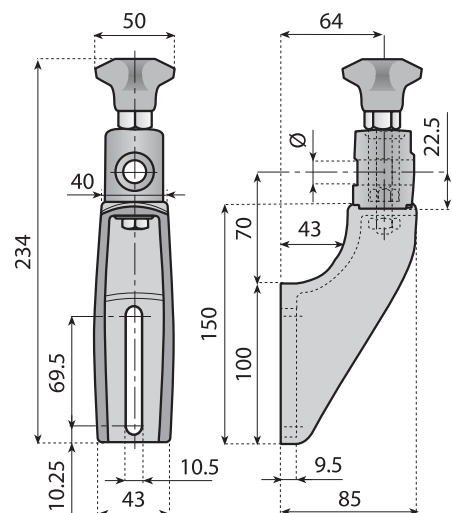

ADJUSTABLE BRACKET

Material: bracket and adjustable head in reinforced polyamide; eyebolt, nut, screws and washer in stainless steel AISI 304; knob in polyamide with nickel plated brass insert.

Note: screw regulates rod position and head adjustability. Max recommended tightening torque 4 Kgm.

Code	For rod Ø (mm)	
13539	12	
13540	14	n°50
13541	16	

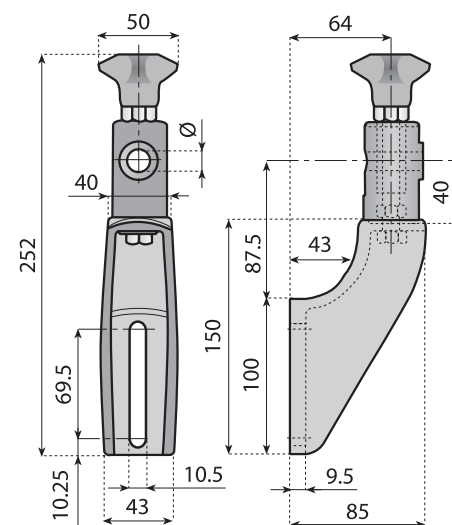

ADJUSTABLE BRACKET

Material: bracket in reinforced polyamide; screw and washer in stainless steel AISI 304; knob in polyamide with nickel plated brass insert.

Note: screw regulates rod position and head adjustability. Max recommended tightening torque 4 Kgm.

Code	Head material	For rod Ø (mm)	
13542	Nickel	12	
13543	plated brass	14	n°50
13544		16	
13545	Stainless steel	12	
13546	AISI 304	14	n°50
13547		16	

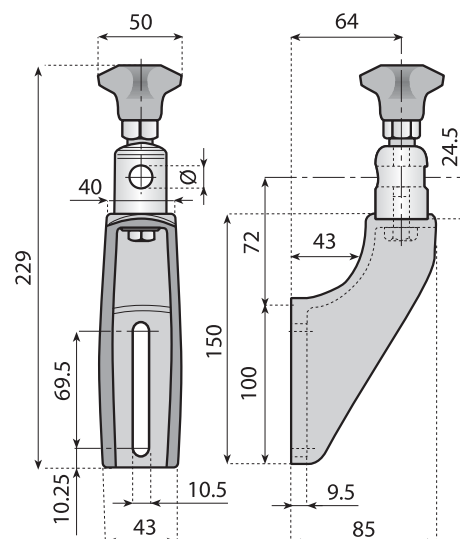

Adjustable brackets

 Preferred type, readily available (codes marked in red)



AISI 304
Stainless steel



Nickel plated brass



Reinforced
polyamide



Accessories



BRACKET WITH TONGUE

Code

13186



n°50



Material

PA-FG

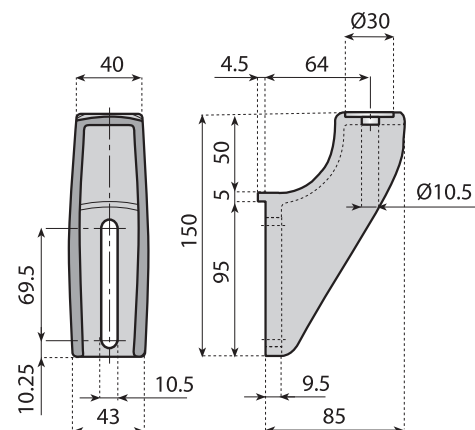

ADJUSTABLE BRACKET

Material: bracket and adjustable head in reinforced polyamide; eyebolt, nut and washer in stainless steel AISI 304.

Note: nut regulates rod position and head adjustability. Max recommended tightening torque 4 Kgm.

Code

13580

13581

13582



For rod
Ø (mm)

12

14

16



n°50

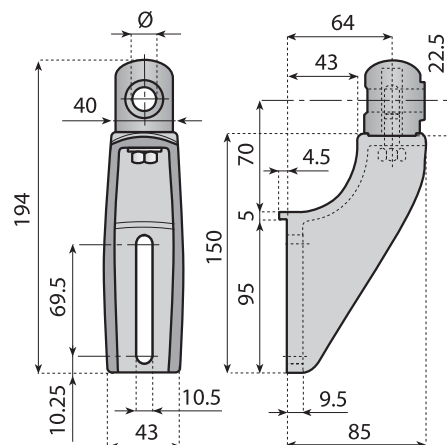

ADJUSTABLE BRACKET

Material: bracket and adjustable head in reinforced polyamide; bolt in nickel plated brass, screw and washer in stainless steel AISI 304.

Note: screw regulates rod position and head adjustability. Max recommended tightening torque 4 Kgm.

Code

13583

13584

13585



For rod
Ø (mm)

12

14

16



n°50

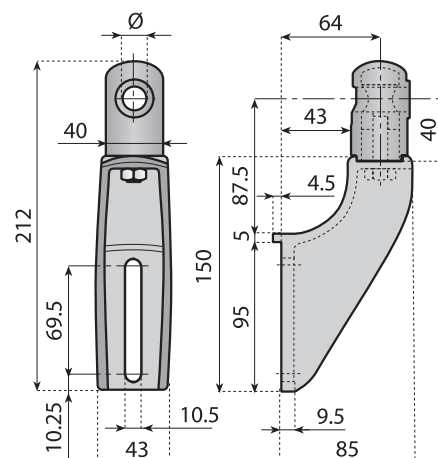

Adjustable brackets

Preferred type, readily available (codes marked in red)



AISI 304
Stainless steel



Nickel plated brass



Reinforced
polyamide



Accessories

ADJUSTABLE BRACKET

Material: bracket and adjustable head in reinforced polyamide; eyebolt, nut, screws and washer in stainless steel AISI 304; knob in polyamide with nickel plated brass insert.

Note: screw regulates rod position and head adjustability. Max recommended tightening torque 4 Kgm.

Code	For rod Ø (mm)	
13586	12	
13587	14	n°50
13588	16	

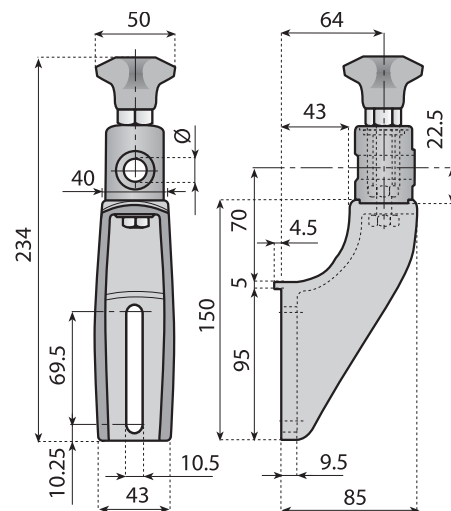

ADJUSTABLE BRACKET

Material: bracket and adjustable head in reinforced polyamide; eyebolt, nut, screws and washer in stainless steel AISI 304; knob in polyamide with nickel plated brass insert.

Note: screw regulates rod position and head adjustability. Max recommended tightening torque 4 Kgm.

Code	For rod Ø (mm)	
13589	12	
13590	14	n°50
13591	16	

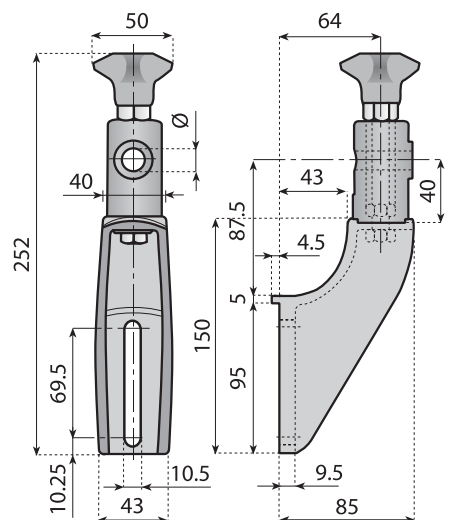

ADJUSTABLE BRACKET

Material: bracket in reinforced polyamide; screw and washer in stainless steel AISI 304; knob in polyamide with nickel plated brass insert.

Note: screw regulates rod position and head adjustability. Max recommended tightening torque 4 Kgm.

Code	Head material	For rod Ø (mm)	
13592	Nickel	12	
13593	plated brass	14	n°50
13594		16	
13595	Stainless steel	12	
13596	AISI 304	14	n°50
13597		16	

