

# Side guide brackets

Preferred type, readily available (codes marked in red)



AISI 304  
Stainless steel



Nickel plated brass



Reinforced  
polyamide



## BRACKET WITH EYEBOLT AND KNOB

**Material:** reinforced polyamide, eyebolt and washer in stainless steel AISI 304, knob in polyamide with nickel plated brass insert.

**Note:** max recommended tightening torque 4 Kgm.

Code	For rod Ø (mm)	
13211	12	n°50
13212	14	

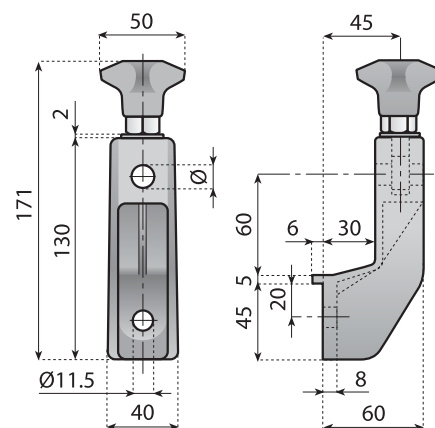

## BRACKET WITH EYEBOLT AND KNOB

**Material:** reinforced polyamide, eyebolt and washer in stainless steel AISI 304, knob in polyamide with nickel plated brass insert.

**Note:** max recommended tightening torque 4 Kgm.

Code	For rod Ø (mm)	
13851	12	n°50
13852	14	

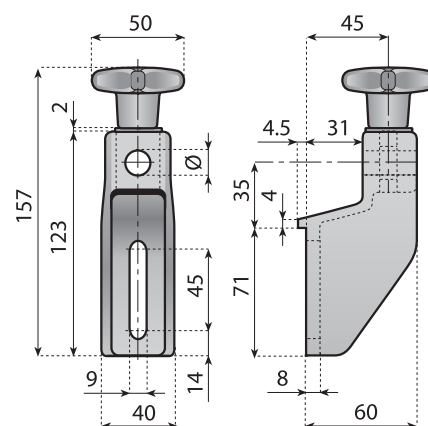

## BRACKET WITH EYEBOLT AND KNOB

**Material:** reinforced polyamide, eyebolt and washer in stainless steel AISI 304, knob in polyamide with nickel plated brass insert.

**Note:** max recommended tightening torque 4 Kgm.

Code	For rod Ø (mm)	
13764	12	n°50
13765	14	

