

### KTR-16.00/.01

Type	Normal .00	Stainless .01	Di +0,15	Da	Load Rating C [daN]
KTR-16x1,0	x	x	14,1	15,9	3

**Other dimensions on request!**

- ☛ Housing: Plastic
- ☛ Inner Race: Plastic
- ☛ Ball
  - ☛ 00: Steel
  - ☛ 01: 1.4034

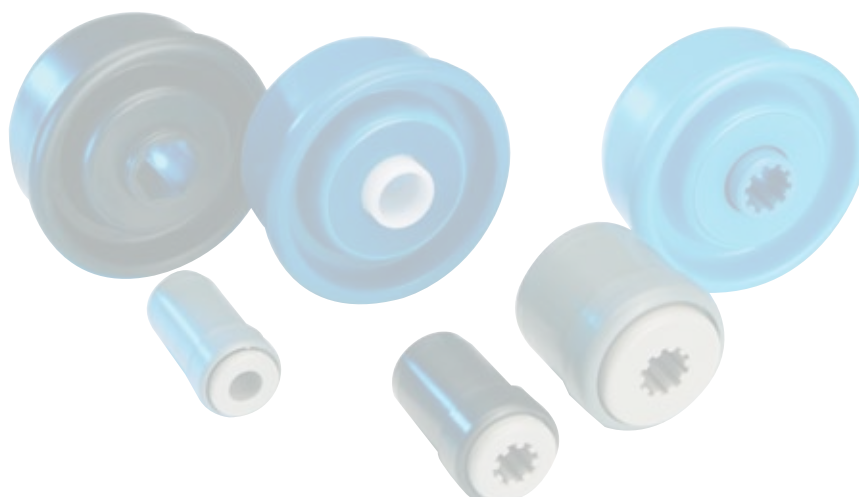

**KTR-16.00  
KTR-16.01**

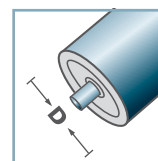

**D [mm]**  
16

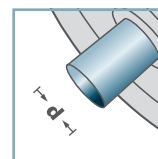

**d [mm]**  
5; 6

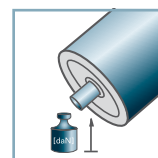

**C [daN]**  
3

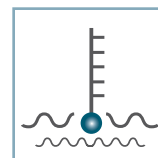

**T [°C]**  
0° - 80°



-



**Carton [pcs.]**

500

# KTR

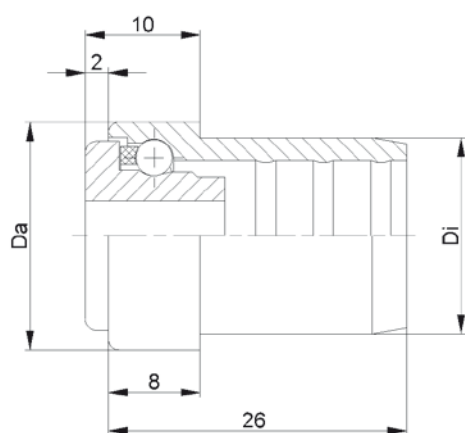

### KTR-20.00/.01

Type	Normal .00	Stainless .01	Di +0,15	Da	Load Rating C [daN]
KTR-20x1,0	x	x	18,1	19,9	5
KTR-20x1,5	x	x	17,1	19,9	5

### Other dimensions on request!

- ☛ Housing: Plastic
- ☛ Inner Race: Plastic
- ☛ Ball Cage: Plastic
- ☛ Ball
  - ☛ 00: Steel
  - ☛ 01: 1.4034



### KTR-20.00 KTR-20.01

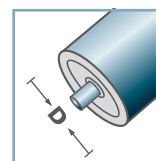

**D** [mm]  
20

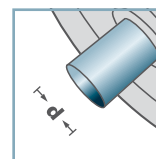

**d** [mm]  
6; 8

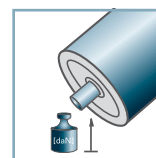

**C** [daN]  
5

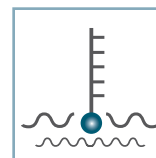

**T** [°C]  
0° - 80°



-



**Carton** [pcs.]

1000

# KTR

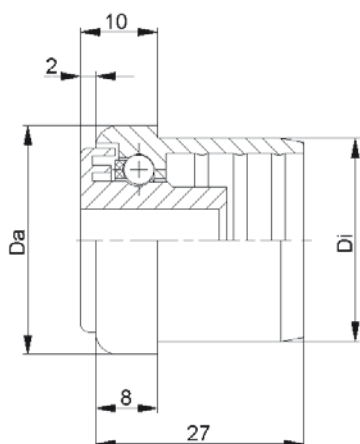

KTR-30.00/.01					
Type	Normal .00	Stainless .01	Di +0,25	Da	Load Rating C [daN]
KTR-30x1,0	x	x	28,1	29,9	7
KTR-30x1,5	x	x	27,1	29,9	7
KTR-30x1,8	x	x	26,5	29,9	7
KTR-30x2,0	x	x	26,35	29,9	7

### Other dimensions on request!

- ☛ Housing: Plastic
- ☛ Inner Race: Plastic
- ☛ Ball Cage: Plastic
- ☛ Ball
  - ☛ 00: Steel
  - ☛ 01: 1.4034

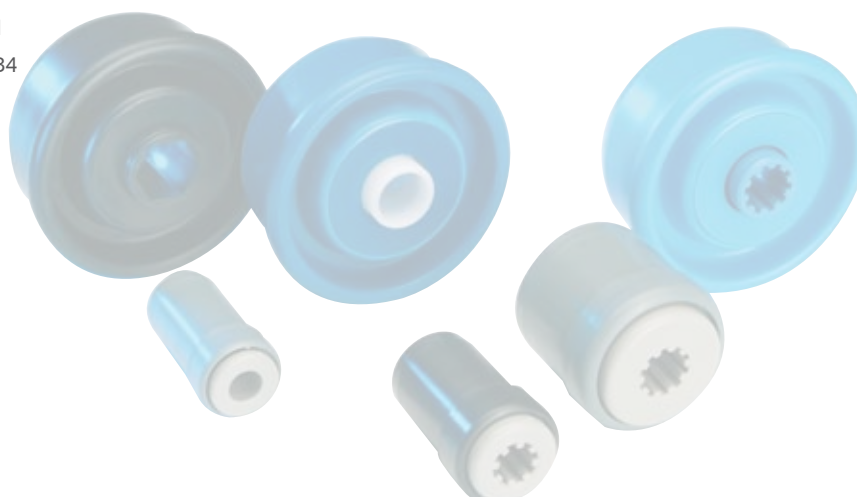

**KTR-30.00**  
**KTR-30.01**

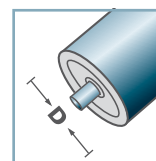

**D** [mm]  
30

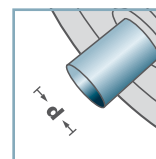

**d** [mm]  
6; 8; 10

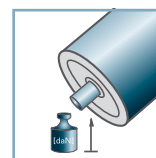

**C** [daN]  
7

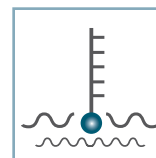

**T** [°C]  
0° - 80°



-



**Carton** [pcs.]

250

# KTR

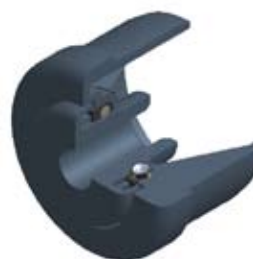
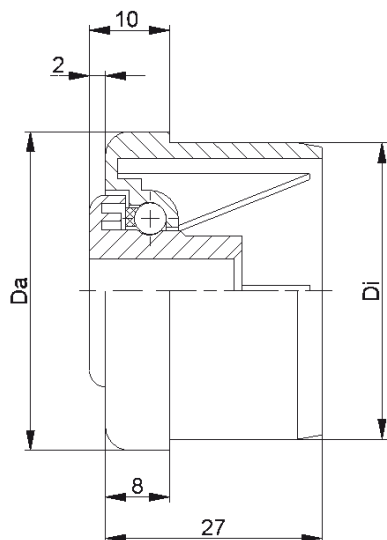

KTR-40.00/.01					
Type	Normal .00	Stainless .01	Di +0,25	Da	Load Rating C [daN]
KTR-40x1,5	x	x	37,1	39,9	7
KTR-40x2,3	x	x	35,5	39,9	7

### Other dimensions on request!

- ☛ Housing: Plastic
- ☛ Inner Race: Plastic
- ☛ Ball Cage: Plastic
- ☛ Ball
  - ☛ 00: Steel
  - ☛ 01: 1.4034

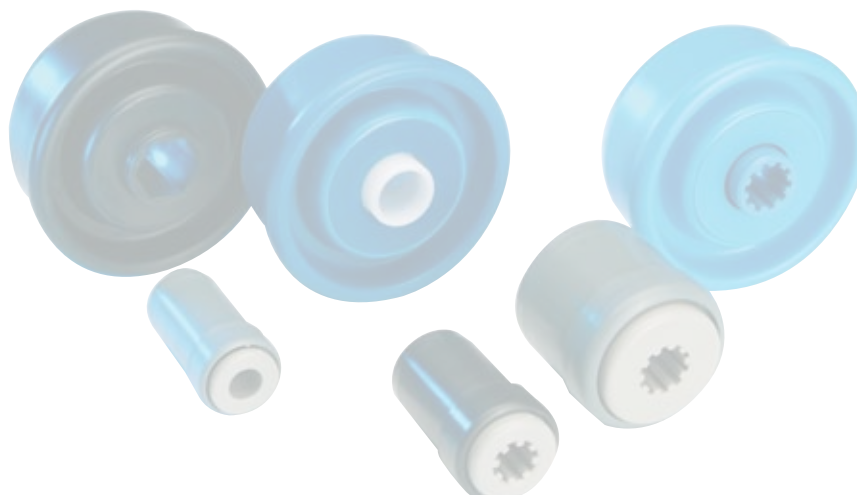

**KTR-40.00**  
**KTR-40.01**

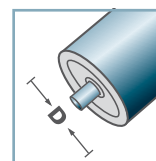

**D** [mm]  
40

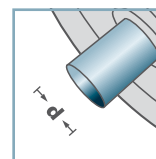

**d** [mm]  
6; 8; 10

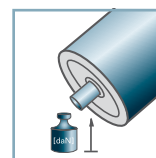

**C** [daN]  
7

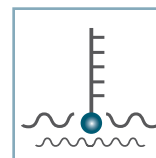

**T** [°C]  
0° - 80°



-



**Carton** [pcs.]

250

# KTR

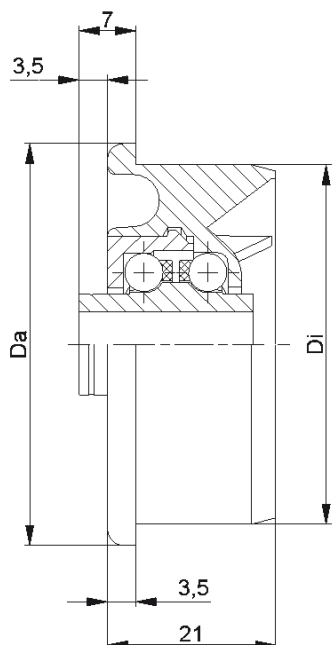

KTR-02/03					
Type	Normal .02	Stainless .03	Di +0,2	Da	Load Rating C [daN]
KTR-50x1,5	x	x	47,3	49,9	10
KTR-50x2,0	x	x	46,3	49,9	10
KTR-50x2,8	x	x	44,6	49,9	10

## Other dimensions on request!

- ☛ Housing: Plastic
- ☛ Inner Race: Plastic
- ☛ Bearing Cap: Plastic
- ☛ Ball Cage: Plastic
- ☛ Ball
  - ☛ 02: Steel
  - ☛ 03: 1.4034



## KTR-02 KTR-03

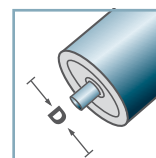

**D** [mm]  
50

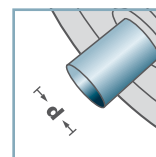

**d** [mm]  
8; 10

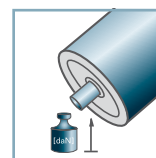

**C** [daN]  
10

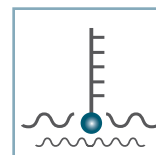

**T** [°C]  
0° - 80°



**Carton** [pcs.]

50x1,5: 250  
50x2,0: 300  
50x2,8: 250

# KTR

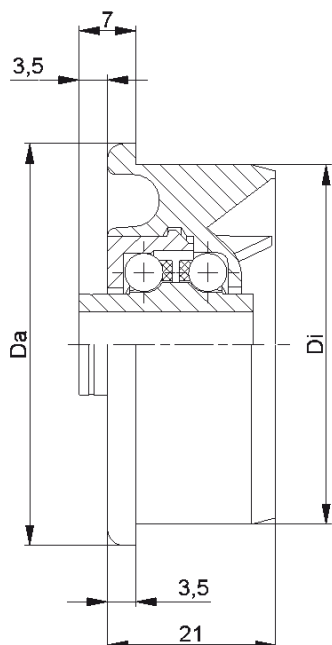

## KTR-02/03

Type	Normal .02	Stainless .03	Di +0,2	Da	Load Rating C [daN]
KTR-50x1,5	x	x	47,3	49,9	10
KTR-50x2,8	x	x	44,6	49,9	10

## Other dimensions on request!

- ☛ Housing: Plastic
- ☛ Inner Race: Plastic
- ☛ Bearing Cap: Plastic
- ☛ Ball Cage: Plastic
- ☛ Ball
- ☛ 02: Steel
- ☛ 03: 1.4034



## KTR-02 KTR-03

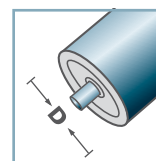

**D** [mm]  
50

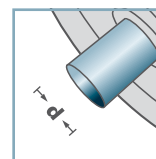

**d** [mm]  
12; SW11

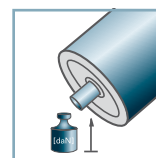

**C** [daN]  
10

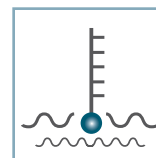

**T** [°C]  
0° - 80°



**Carton** [pcs.]

250

# KTR

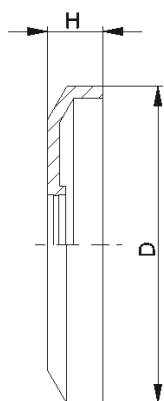

DK-KTR		
Type	D	H
DK-KTR-02	40,5	7
Other dimensions on request!		

Seal Bonnet: Plastic



## DK-KTR-02

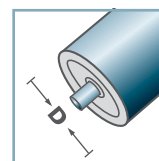

D [mm]

-

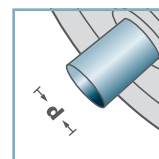

d [mm]

-

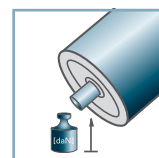

C [daN]

-

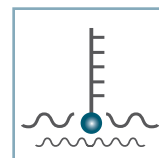

T [°C]

0° - 80°



-



Carton [pcs.]

-

# KTR

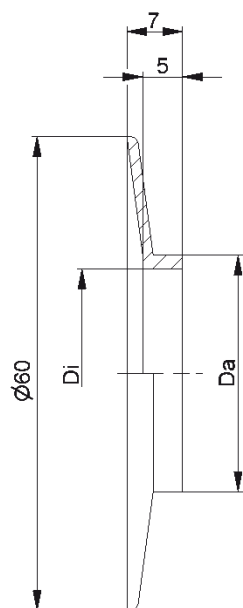

BS-		
Type	Di	Da
BS-30x1,0	28,1	29,9
BS-30x1,8	26,5	29,9
BS-40x1,5	37,1	39,9
BS-40x2,3	35,5	39,9
Other dimensions on request!		

🔧 Wheel Flange: Plastic



**BS-**

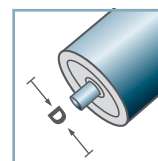

**D** [mm]

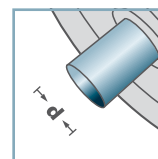

**d** [mm]

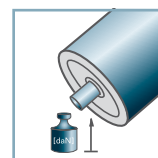

**C** [daN]

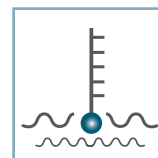

**T** [°C]  
0° - 80°



-



**Carton** [pcs.]



# KTR