

# Clamps for standard side guides



Nickel  
plated brass



303 Stainless steel



Reinforced  
polyamide



See page  
95



Consult pages  
134 → 137  
for rod design

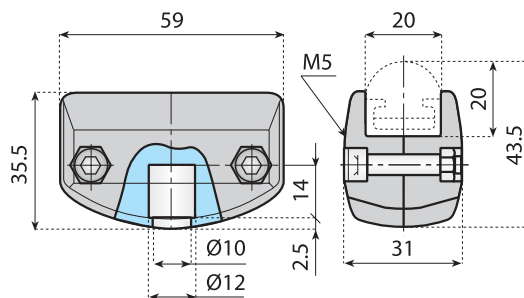

Code

13001

## SINGLE CLAMP

**Material:** clamp in reinforced polyamide, bolt in stainless steel, nut in nickel plated brass.

**Supply:** assembled.

**Packaging:** 100 pieces.

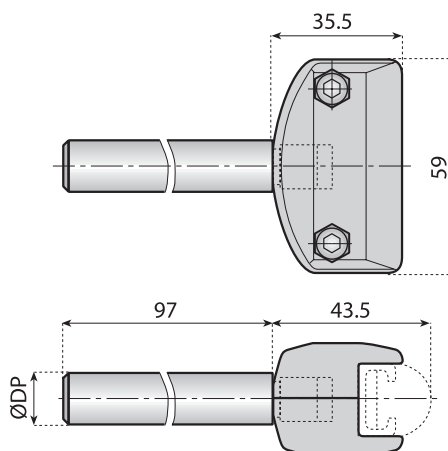

Code

DP

13002

12

13003

14

13004

16

## SINGLE CLAMP WITH ROD

**Material:** clamp in reinforced polyamide, bolt in stainless steel, nut in nickel plated brass, rod in stainless steel AISI 303.

**Supply:** unassembled.

**Packaging:** 50 pieces.

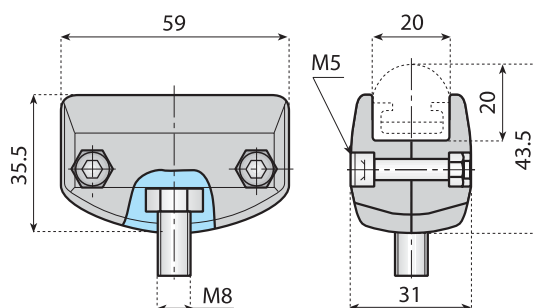

Code

13184

## SINGLE CLAMP

**Material:** clamp in reinforced polyamide, bolt in stainless steel, nut in nickel plated brass.

**Supply:** assembled.

**Packaging:** 100 pieces.

# Clamps for standard side guides



Nickel  
plated brass



303 Stainless steel



Reinforced  
polyamide



See page  
95



Consult pages  
134 → 137  
for rod design



## SINGLE CLAMP WITH ROD

**Material:** clamp in reinforced polyamide, bolt in stainless steel, nut in nickel plated brass, rod in stainless steel AISI 303.

**Supply:** unassembled.

**Packaging:** 50 pieces.

Code	DP
13797	12
13798	14
13799	16

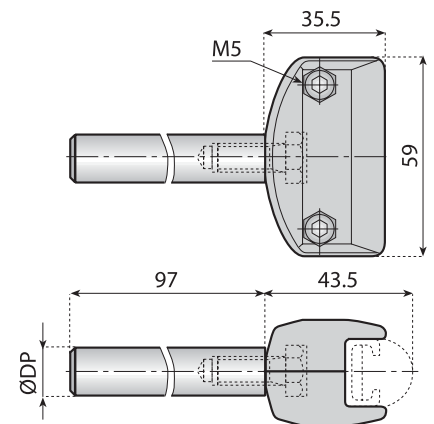

## ADJUSTABLE SINGLE CLAMP

**Material:** clamp in reinforced polyamide, bolt in stainless steel, nut in nickel plated brass.

**Supply:** assembled.

**Packaging:** 50 pieces.

Code	
13005	

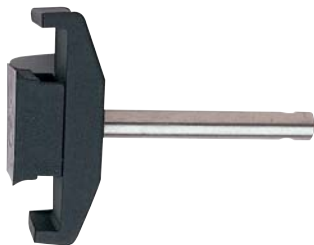
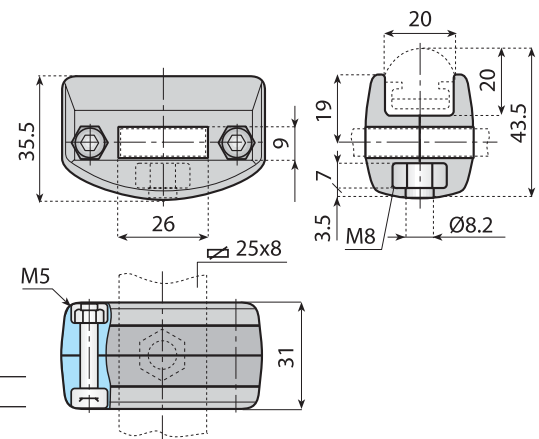

## DOUBLE CLAMP WITH ROD

**Material:** clamp in reinforced polyamide, nut and rod in stainless steel.

**Note:** code 13525 is supplied without rod.

**Supply:** unassembled.

**Packaging:** 50 pieces.

Code	DP
13525	-
13526	12
13527	14
13720	16

