

Chain guide wear strip (accessories)

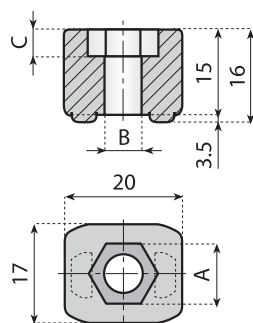

Reinforced
polyamide



FIXING CLAMP

Material: reinforced polyamide.

Packaging: 100 pieces.

Application: rapid wear strip assembly with M6 or M8 screws.

Notes: screws are not included.

Code	A mm	B mm	C mm	Screws
14108	10	6.2	4.5	M6
14109	13	8.2	6	M8

New
design

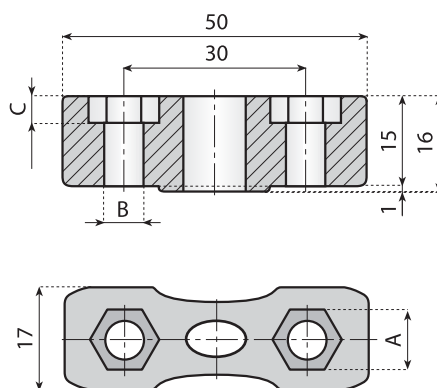
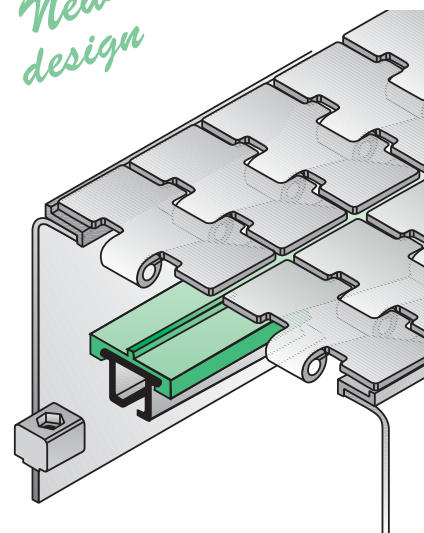

CONNECTING ELEMENT

Material: reinforced polyamide.

Packaging: 100 pieces.

Notes: screws are not included.

Code	A mm	B mm	C mm	Screws
14075	10	6.2	4.5	M6
14111	13	8.2	6	M8

New
design

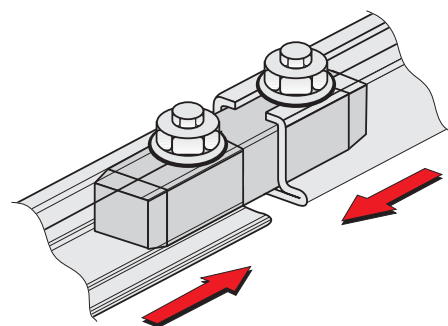

Wear strip shoe for steel profile

WEAR STRIP SHOE

Application: shoes are used to help chain guide between idler wheels and wear strip and must be fixed with M6 screws.



Polyamide



Accessories

New design

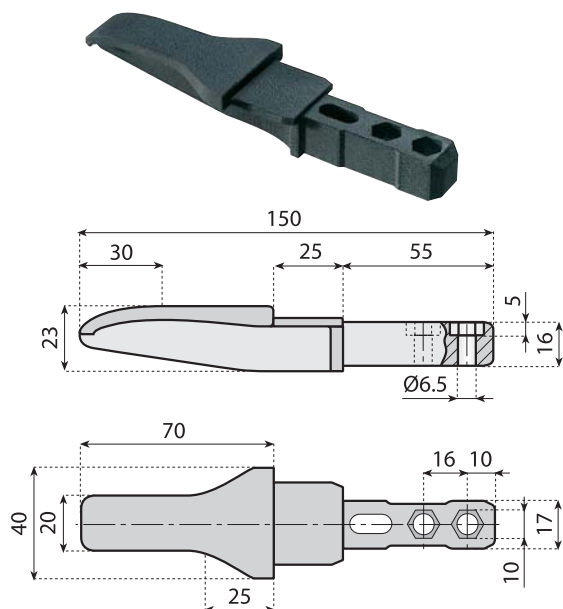

WEAR STRIP SHOE

Material: polyamide.

Packaging: 50 pieces.

Application: with chain L 82,5 - K325.

Code	Colour
14090	Black
14090V	Green

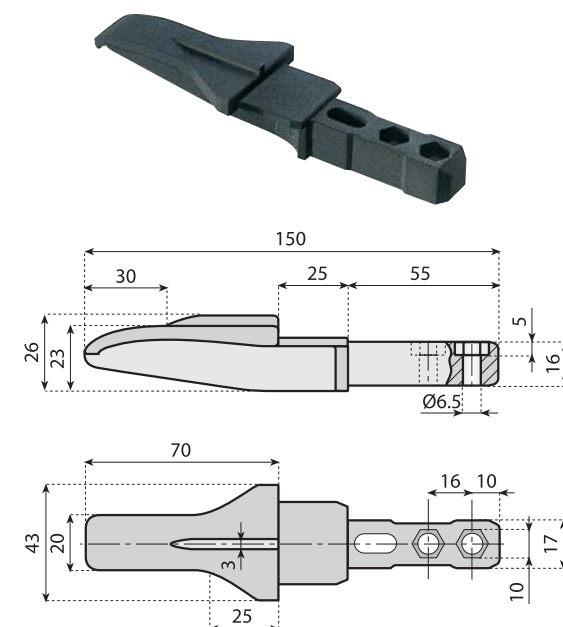

WEAR STRIP SHOE

Material: polyamide.

Packaging: 50 pieces.

Application: with chain L 82,5 - K325 pitch P = 88 mm.

Code	Colour
14091	Black
14091V	Green

APPLICATION EXAMPLE

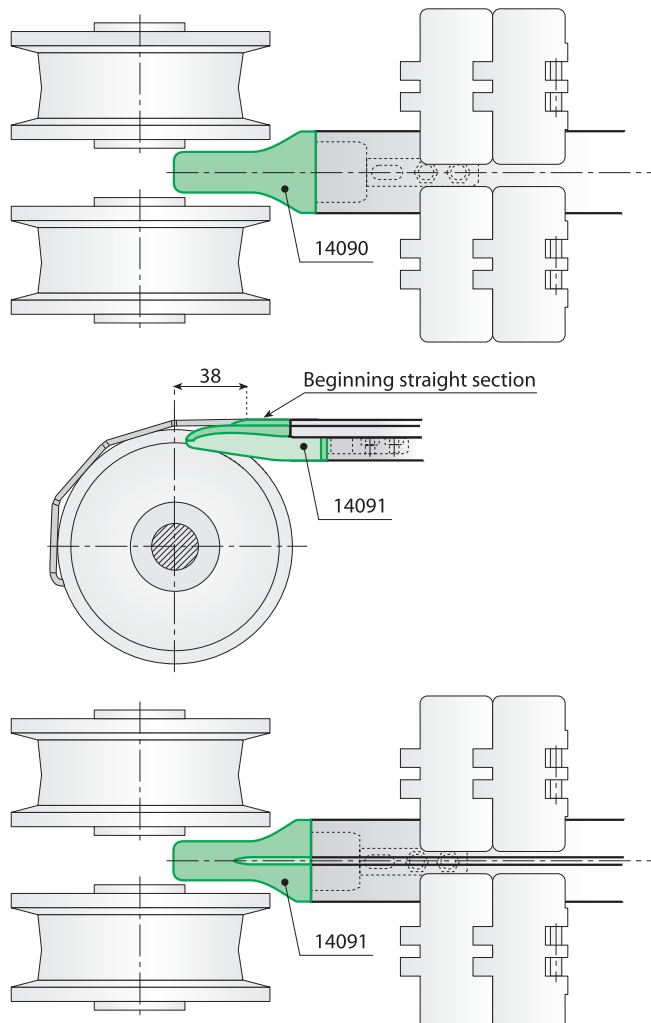

Wear strip shoe for steel profile



WEAR STRIP SHOE

Application: shoes are used to help chain guide between idler wheels and wear strip and must be fixed with M6 screws.



Polyamide



Accessories

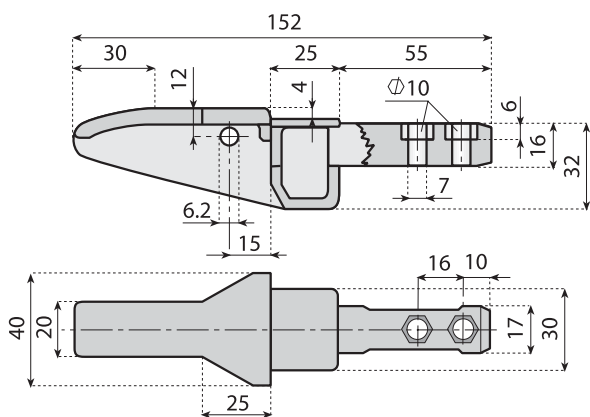

Heavy Duty



WEAR STRIP SHOE

Material: polyamide.

Packaging: 50 pieces.

Application: with chain L 82,5 - K325.

Code	Colour
14110	Black
14110V	Green

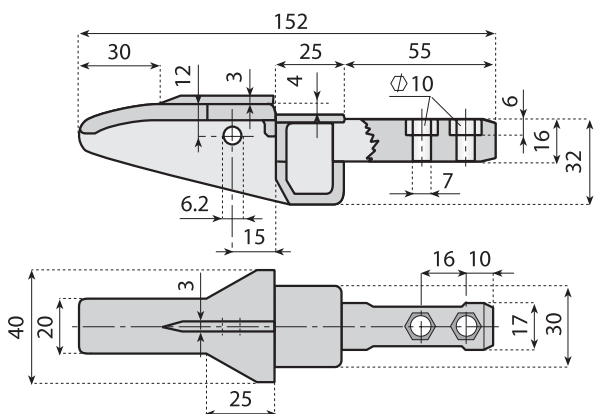

WEAR STRIP SHOE

Material: polyamide.

Packaging: 50 pieces.

Application: with chain L 82,5 - K325 pitch P = 88 mm.

Code	Colour
14110T	Black
14110TV	Green

APPLICATION EXAMPLE

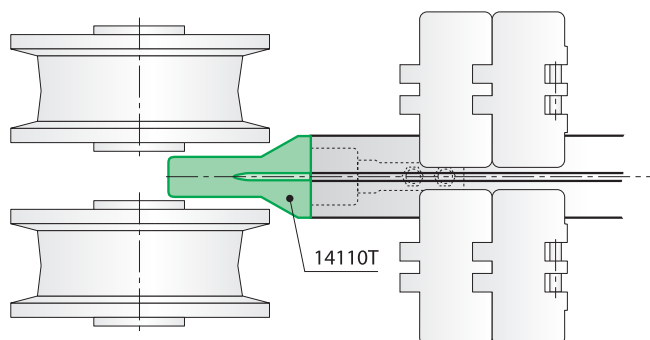
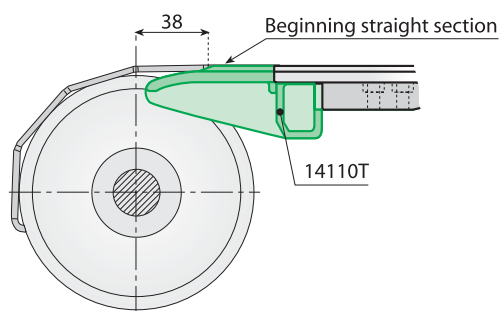
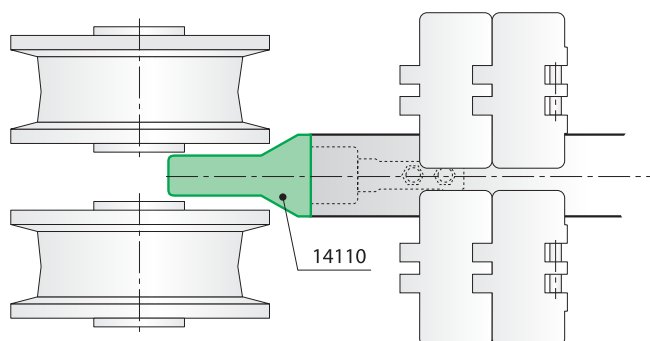

Chain guide wear strip (accessories)

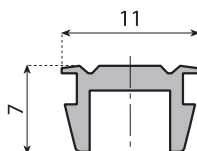

Thermoplastic rubber



Reinforced polyamide

PROTECTION TAPE

Material: rubber.

Packaging: 30 meters.

Application: protection of steel profile against infiltration of liquids and dust.

Code

19049

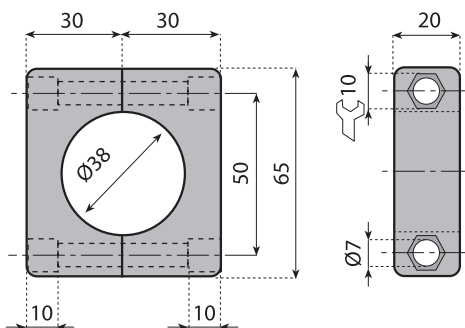
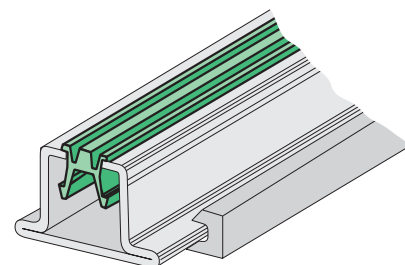

WEAR STRIP CLAMP

Material: reinforced polyamide.

Packaging: 50 pieces.

Application: support of wear strip.

Notes: screws are not included.

Code

14347

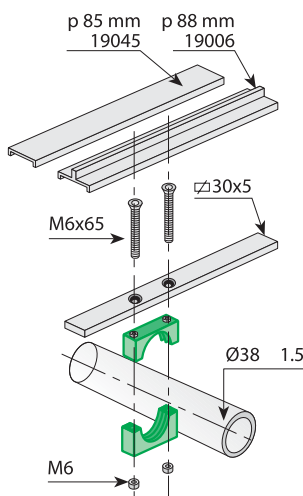

APPLICATION EXAMPLE

